

**INDUSTRIAL SPACE  
FOR SALE 29,212 SF**

**PROPERTY FEATURES**

- 29,212± SF total building
  - 26,212 SF main building
  - 3,000 SF garage
- 2,012 SF office space
- 1.8 Acres
- (2) dock doors
- (7) drive-in doors
- Seven (7) cranes
- Zoned PEC
- Easy access to I-64 and I-265

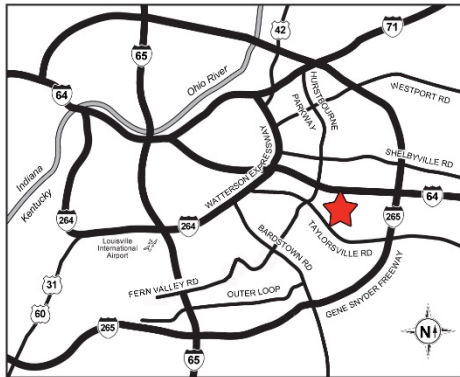

**EAST SUBMARKET  
BLUEGRASS COMMERCE PARK**



| CRANE SPECIFICATIONS |                    | DOCK DOORS                           | DRIVE-IN DOORS                       |
|----------------------|--------------------|--------------------------------------|--------------------------------------|
| 5 Ton                | 16' Hook Height    | (1) 10' x 12' with levelers          | (2) 20' x 14'                        |
| 5 Ton                | 16' Hook Height    | (1) 12' x 12' (In "Garage" Building) | (1) 14' x 14'                        |
| 3 Ton                | 15' 5" Hook Height |                                      | (1) 12' x 12"                        |
| 3 Ton                | 16' Hook Height    |                                      | (1) 14' x 16'                        |
| 3 Ton                | 16' Hook Height    |                                      | (2) 12' x 12' (In "Garage" Building) |
| 2 Ton                | 16' Hook Height    |                                      |                                      |
| 1 ton                | 11' Hook Height    |                                      |                                      |

\*Crane sizes and hook heights are believed to be correct but are not warranted to be correct.

For more information, please contact:

**ROBERT B. WALKER, SIOR, CCIM**  
Senior Director  
**Certified Supply Chain Professional**  
+1 502 589 5150 ext. 254  
rwalker@commercialkentucky.com

**JAKE MILLS**  
Associate  
+1 502 589 5150 ext. 202  
jmills@commercialkentucky.com

333 E. Main Street, Suite 510  
Louisville, KY 40202  
phone: +1 502 589 5150  
www.commercialkentucky.com

**FOR SALE**  
**2811 WATTERSON TRAIL**  
Louisville, KY 40299

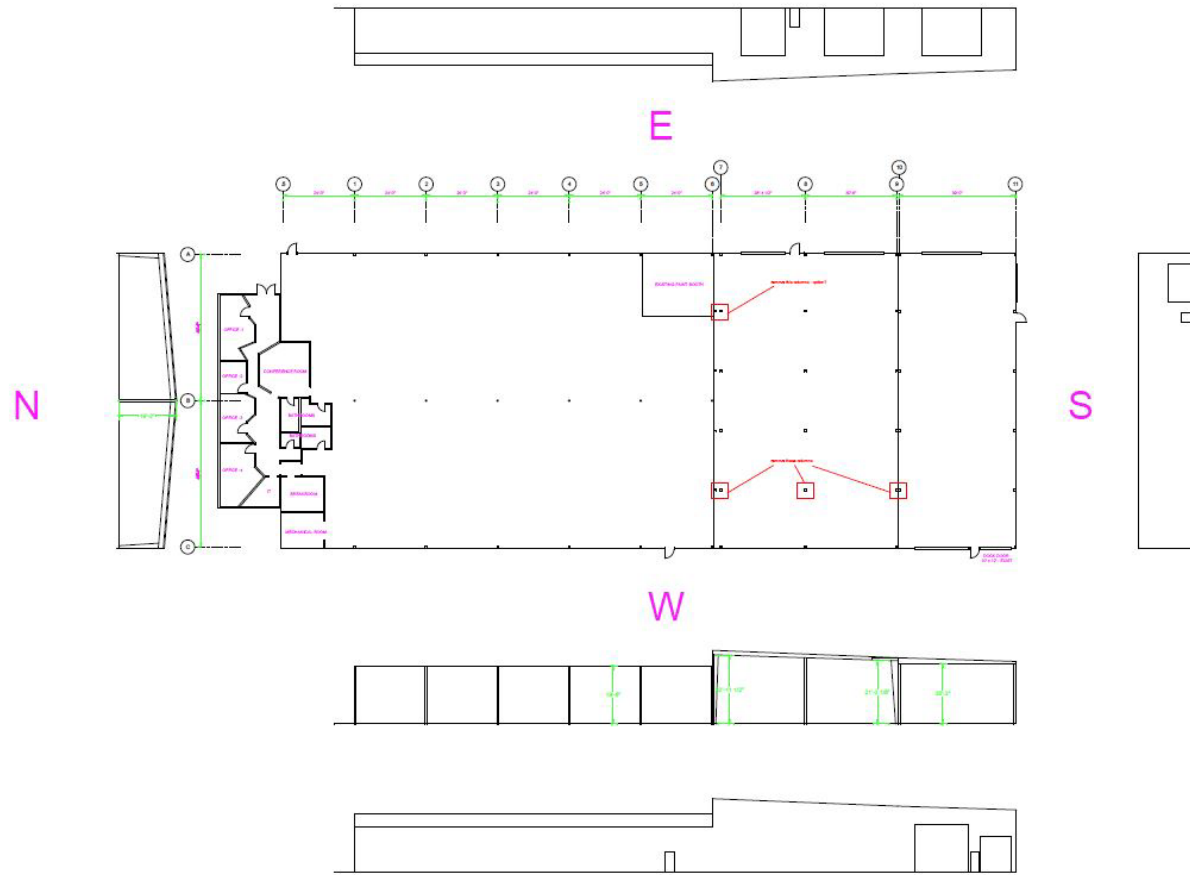

**CAD Drawing**



**Aerial**

For more information, please contact:

**ROBERT B. WALKER, SIOR, CCIM**  
Senior Director  
**Certified Supply Chain Professional**  
+1 502 589 5150 ext. 254  
rwalker@commercialkentucky.com

**JAKE MILLS**  
Associate  
+1 502 589 5150 ext. 202  
jmills@commercialkentucky.com

333 E. Main Street, Suite 510  
Louisville, KY 40202  
phone: +1 502 589 5150  
www.commercialkentucky.com